



**Flat 7 11 St. Lukes Road, Maidenhead, SL6 7AJ**  
**£175,000 Leasehold**

CHAIN FREE A second floor one bedroom apartment. Well presented throughout with double aspect kitchen/sitting room, electric heating, parking space and easy reach of the town centre and Elizabeth line station.

### **Security Entryphone System**

Door giving access to

### **Communal Entrance Hall**

Stairs rising to second floor landing.

### **Entrance Hall**

### **Bathroom**

Panel enclosed bath with hand held shower attachment, glazed screen, close coupled WC, pedestal wash hand basin, heated towel rail, tiled floor

### **Bedroom**

### **Kitchen/Sitting room**

Newly fitted kitchen, floor mounted units and drawers, electric oven and hob with extractor fan over, tiled splashbacks, work surfaces incorporating inset stainless steel sink, breakfast bar, storage cupboard, space for washing machine, double aspect

### **Outside**

Residents parking.

Floor Plan

Approximate Floor Area = 36.1 sq m / 388 sq ft

St Lukes Road

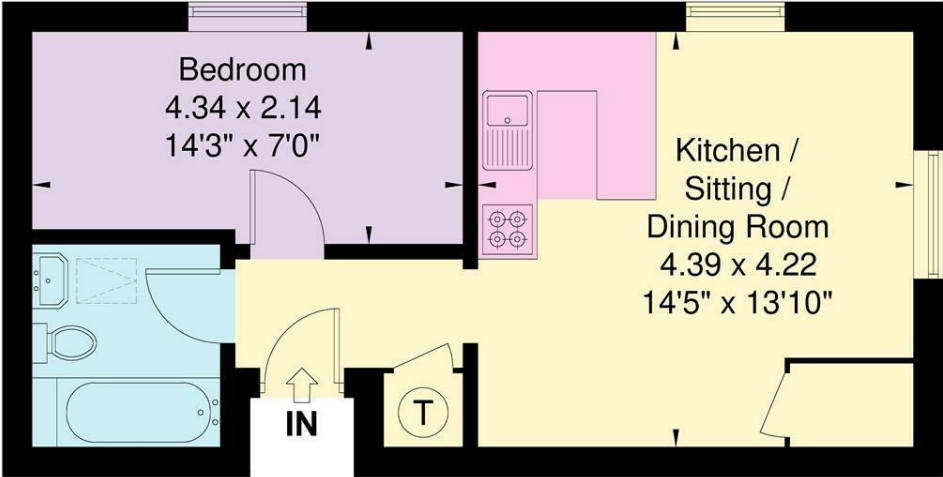

Second Floor

Illustration for identification purposes only, measurements are approximate, not to scale.

Area Map



Energy Efficiency Graph

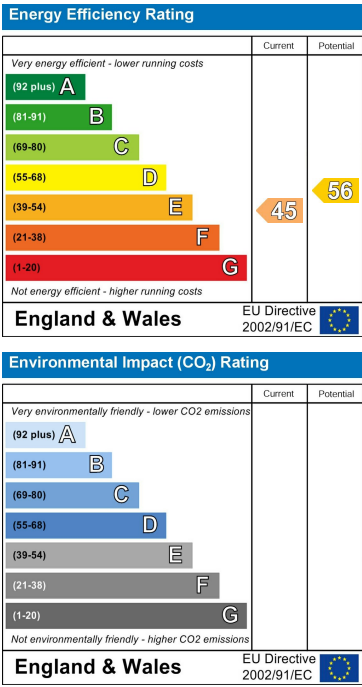

These particulars, whilst believed to be accurate are set out as a general outline only for guidance and do not constitute any part of an offer or contract. Intending purchasers should not rely on them as statements of representation of fact, but must satisfy themselves by inspection or otherwise as to their accuracy. No person in this firms employment has the authority to make or give any representation or warranty in respect of the property.